

# COLLEGE TOWN KENT: THE LANDMARK



KENT STATE UNIVERSITY | KENT, OHIO

The Landmark, which opened 100% leased in the Spring of 2014, is located in the heart of Kent's new \$100 million mixed-use downtown district. Restaurants, trendy shops, a boutique hotel, nightlife and professional offices are all easily accessible to residents. With a variety of dining experiences, from white table cloth and wine bars to fast casual and coffee shops, residents can immerse themselves in the vibrant downtown streetscape both day and night. At home, they can enjoy luxury living with spacious floor plans, high-end finishes, walk-in closets, in suite washer and dryer and a private fitness room. The Landmark at Kent is truly a retreat for young professionals, empty nesters and those looking for sophisticated urban living.

## KENT, OHIO



## AREA DEMOGRAPHICS

KENT, OHIO	1 MI. RADIUS	3 MI. RADIUS	5 MI. RADIUS
POPULATION	10,988	42,402	88,631
AVG. HOUSEHOLD INCOME	\$52,491	\$55,723	\$64,414
% WITH INCOME \$75,000 +	22.90%	25.70%	31.20%
% WITH BACHELOR'S DEGREE +	41.10%	37.50%	33.00%



## THE LANDMARK AT A GLANCE

The Landmark at Kent offers a high-end luxury apartment lifestyle in the heart of a college town. Within walking distance of Kent State University and the beautiful riverwalk on the Cuyahoga River, The Landmark at Kent has it all at your front door. Selected amenities include:

- Granite Countertops
- Walk-in Closets
- Adjacent Hotel for Guests
- French Balconies
- Large Bedrooms
- Stainless Steel Appliances
- Spacious Living Areas

**Robert Moore**  
 210 S. Depeyster St.  
 Kent, Ohio 44240  
 p. 330-346-0644 cell. 216-956-6457  
 rmoore@fairmountproperties.com  
[www.fairmountproperties.com](http://www.fairmountproperties.com)

### One Bedroom / One Bath

OPENING AT \$995 PER MONTH

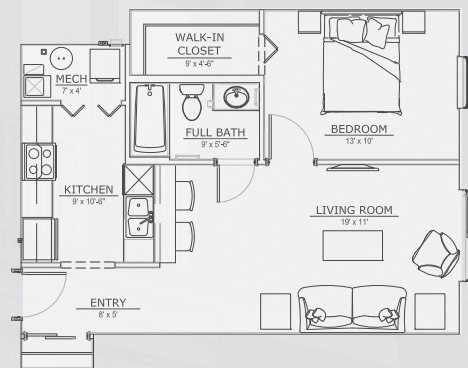

### Two Bedroom / Two Bath

OPENING AT \$1,380 PER MONTH

